

Cemented Carbide Mining Tools



About US

With more than 20 years of experience in cemented carbide industry, Yatech provides the best product solutions for precision stamping, cutting tools, drawing dies, steel, agricultural machinery, food machinery and other industries.

Through excellent product quality and reliability, Yatech efficient products and high-quality services can help you win the market quite well.

Working with customers to develop material solutions in new fields is the cornerstone of our sustainable development.



Products

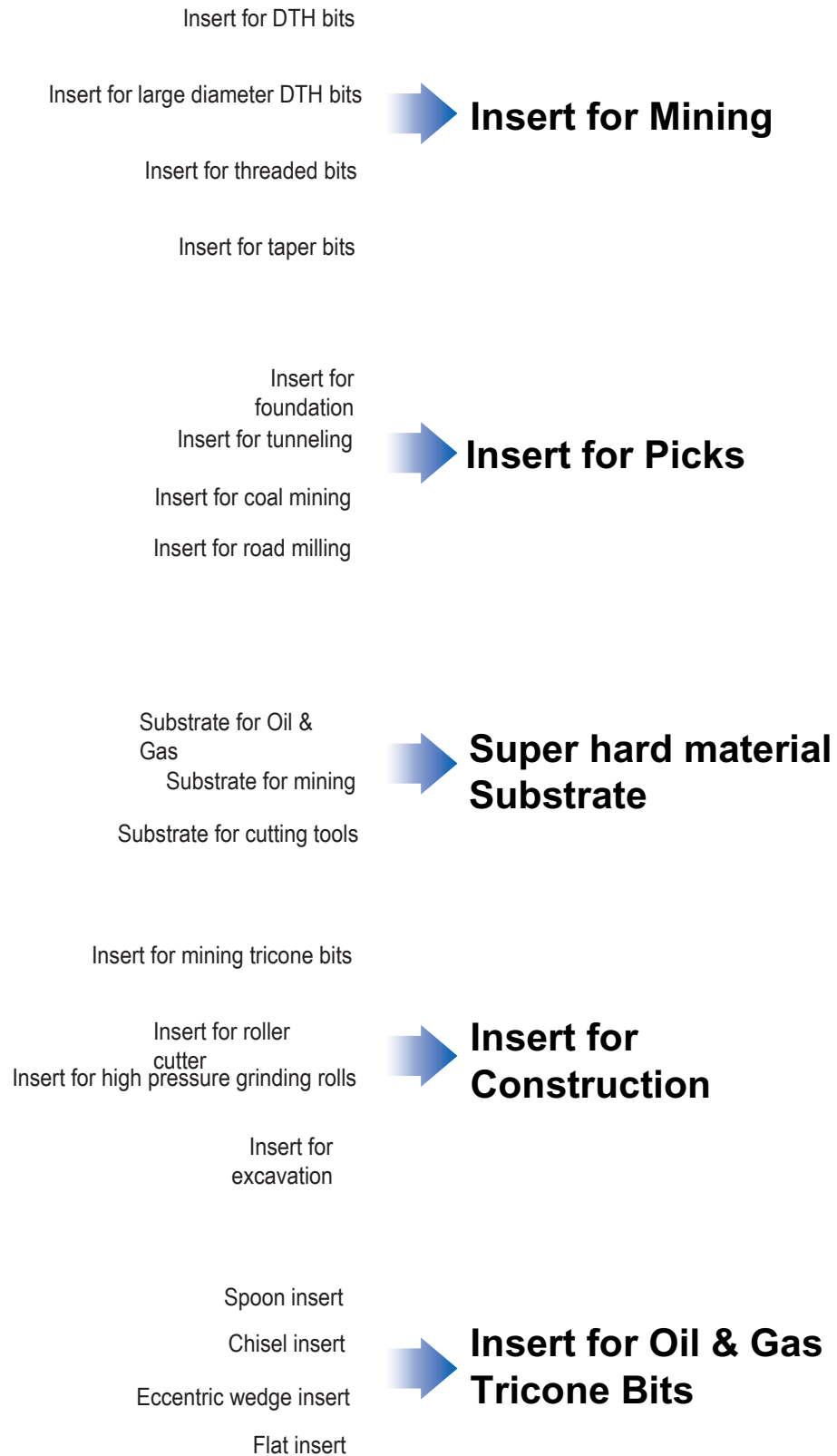



High Precision Equipment

Automatic and highly efficient inclinable ball mill and spray drier system; high precision fully automatic TPA press; imported hip sintering furnaces; temperature and humidity controlled production environment, the automatized production equipment, guarantee in all round way the stability of products' quality and the high efficiency of production.

specializes in R&D, production and sales of drilling cemented carbide. The products are complete in grade and types with mature technology. It has now become an important strategic cooperative partner with oil field, mines, engineering projects and infrastructure construction etc.



Quality Assurance System

The most advanced cemented carbide production equipment, clean and tidy, dust free, temperature and humidity controlled production environment, precision cemented carbide measurement equipment have provided the company a dependable platform for manufacturing high quality products.

Imported internationally leading production process for cemented carbide and the overall implementation of ISO9001 quality control system make the products quality stabilized and trusted.

First-class equipment, advanced process and senior technical personnel enable us to provide high-end products.

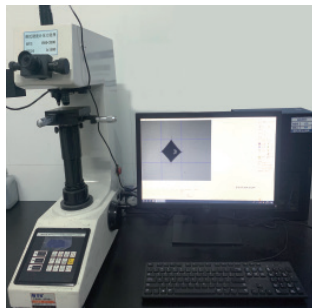

Vickers Hardness Tester



Wear Resistance Tester



Dimension Measurement Instrument



Scanning Electron Microscope

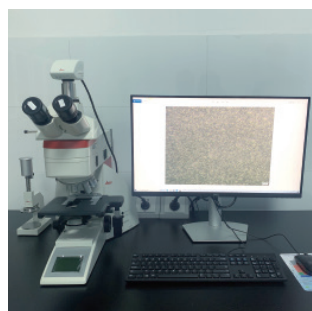

Metallographic Microscope



Rockwell Hardness Tester

A

Insert for Mining



Grade	Cobalt (%) ± 0.5	Density (g/cm ³) ± 0.1	Hardness (HRA) ± 1.0	TRS(Mpa)	Recommended Application
YK06V	6	14.97	90.5	3100	1. High air pressure DTH bits; 2. Threaded bits; Suitable for hard and extra hard formation; Insert features longer life.
YK06L	6	14.95	90.2	3000	1. High air pressure DTH bits; 2. Threaded bits; Suitable for hard and extra hard formation.
YK06H	6	14.95	90.0	2800	1. High air pressure DTH bits; 2. Threaded bits; Suitable for medium-hard formation.
YK06	6	14.95	90.0	2600	1. Low air pressure DTH bits; 2. Taper bits; Suitable for medium-soft formation.
YK07K	7	14.85	89.5	2900	1. Large diameter DTH bit; Suitable for majority of formation.
YK07L	7	14.85	89.5	3000	1. Threaded bits that can be reground; Especially suitable for hard or high compressive strength formation.
YK07HD	7	14.85	89.0	2900	1. DTH bits for soft formation; 2. Extra large diameter DTH bits; 3. Extra high compressive strength formation.
YK30	8	14.75	88.5	2800	1. Welded DTH bits; 2. Suitable for complex medium-soft formation.

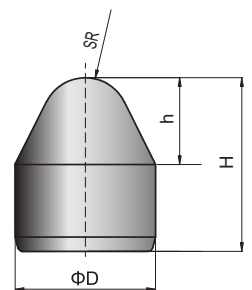
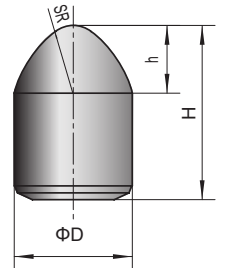
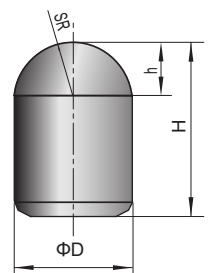



Suitable for DTH, threaded and taper bits, products quality is in the leading position in the industry. Products can be customized according to clients' request.





B

Insert for Picks



Suitable for foundation, tunneling, coal mining and road milling, products quality is in the leading position in the industry. Products can be customized according to clients' request.

Grade	Cobalt (%) ± 0.5	Density (g/cm ³) ± 0.1	Hardness (HRA) ± 1.0	TRS(Mpa)	Recommended Application
YJ06	6	14.95	87.5	2600	Suitable for asphalt and mixed road milling; Insert features: high wear and thermal fatigue resistance as well as impact toughness.
YJ06R	6	14.95	88.0	2600	Suitable for concrete road milling; Insert features: high wear resistance and impact toughness.
YJ35H	8	14.75	86.5	2400	Suitable for medium-hard formation foundation; Insert features: high wear resistance and long service life.
YJ35L	8	14.75	85.5	2400	Suitable for medium-hard formation coal mining, tunneling and foundation; Insert features: high impact toughness.
YJ35V	8	14.75	85.5	2600	Suitable for medium hard formation coal mining, tunneling and foundation; Insert features: higher impact toughness, thermal fatigue resistance and longer service life.
YJ38	10	14.50	86.0	2600	Suitable for medium soft formation coal mining, tunneling and foundation; Insert features: high wear resistance and long service life.
YJ38H	10	14.50	85.5	2600	Suitable for medium hard formation coal mining, tunneling and foundation; Insert features: higher impact toughness.

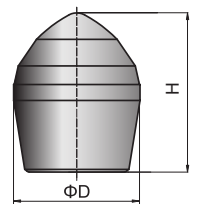
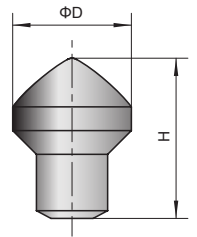
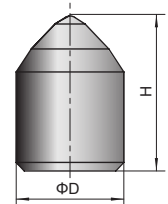
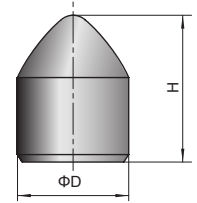



Suitable for oil & gas and mining PDC cutter and PCD cutting tools, products quality is in the leading position in the industry. Products can be customized according to clients' request.

C

Super Hard Material Substrate

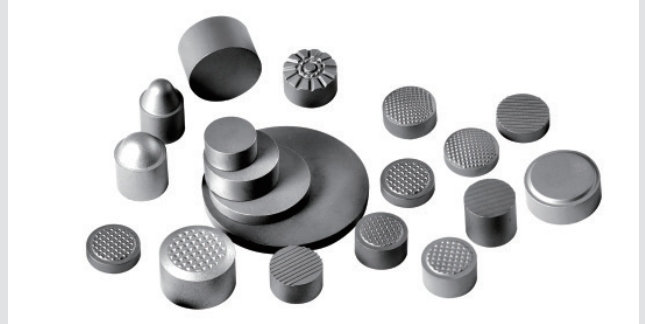

Grade	Cobalt (%) ± 0.5	Density (g/cm ³) ± 0.1	Hardness (HRA) ± 1.0	TRS(Mpa)	Recommended Application
KK60	16	13.95	85.5	2800	Suitable for geothermal and coal field exploitation PDC cutter.
KY40X	11	14.45	89.0	3300	Suitable for oil & gas exploitation PDC Cutter.
KY45X	13	14.25	88.5	3400	Suitable for oil & gas exploitation PDC Cutter.
KY60X	16	13.95	86.5	3000	Suitable for geothermal and coal field exploitation PDC cutter.
KFD40	11	14.45	88.0	3100	Suitable for PCD cutting tool.
KFD45	13	14.25	88.0	3100	Suitable for PCD cutting tool.

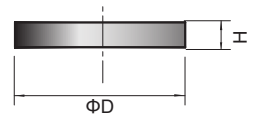
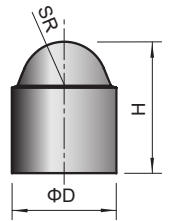
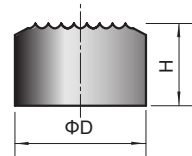
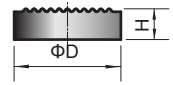

D

Insert for Construction

Grade	Cobalt (%)±0.5	Density (g/cm ³)±0.1	Hardness (HRA)±1.0	TRS(Mpa)	Recommended Application
KK38Y	10	14.50	88.0	3000	1. Mining tricone bits; 2. Suitable for extra hard formation or nonferrous metals mine.
KK40Y	11	14.40	87.5	3000	1. Mining tricone bits; Insert profile: short crown height and simple crown shape; 2. Suitable for medium hard or hard formation.
KK38	10	14.50	87.5	2900	1. Mining tricone bits for medium hard formation, Insert features: high wear resistance; 2. Roller and disc cutter for medium hard formation.
KK40	11	14.40	87.0	2900	1. Insert profile: short crown height and simple crown shape; 2. Suitable for medium soft or hard formation.
KK45	13	14.25	86.5	2900	Roller cutter on medium formation with medium abrasive resistance and compressive strength.
KK245	22	13.40	83.0	2800	Insert features: toughness is better than kG16C and it has good impact resistance. Suitable for roller cutter on hard to extra hard formation with high compressive strength.
KY40	11	14.40	87.5	2900	1. Roller cutter; Insert profile: short crown height and simple crown shape; 2. Suitable for medium soft or hard formation.
KY60	16	13.95	86.5	3100	Insert features: high wear resistance and toughness; Suitable for roller cutter on medium hard to hard formation.
YG16C	16	13.95	84.5	2600	Insert features: toughness is better than YY60 and it has good impact resistance. Suitable for roller cutter on hard formation with high compressive strength.

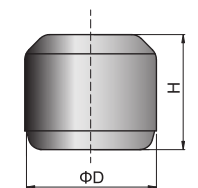
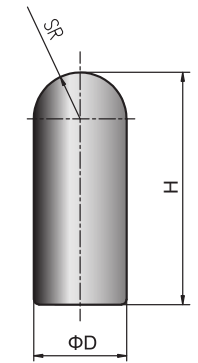
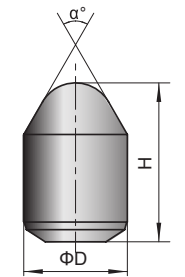
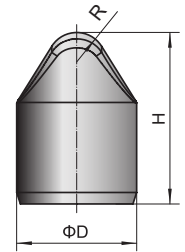

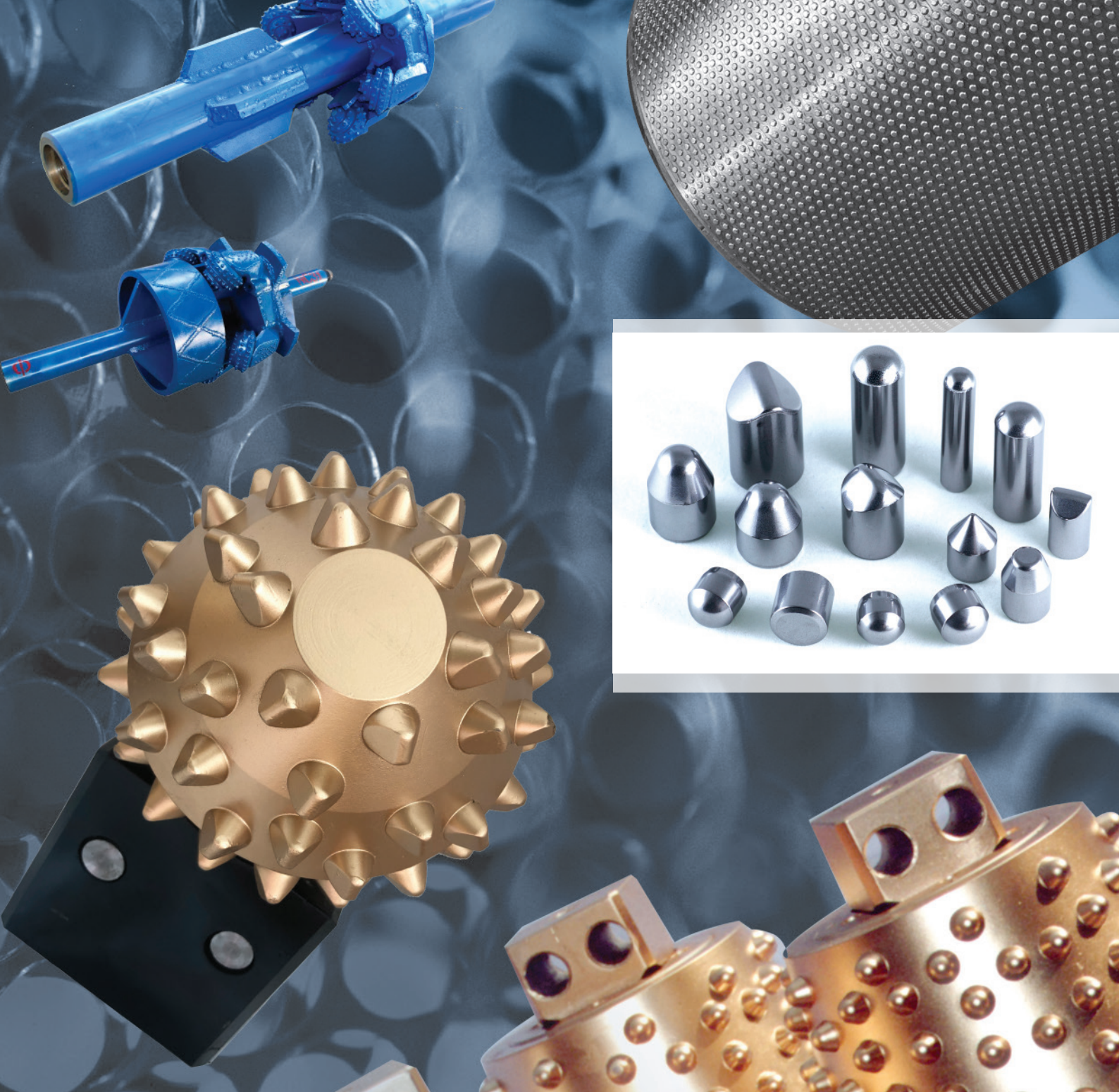

Suitable for mining tricone bits, roller cutter, high pressure grinding rolls and excavation, products quality is in the leading position in the industry. Products can be customized according to clients' request.

Grade	Cobalt (%)±0.5	Density (g/cm³)±0.1	Hardness (HRA)±1.0	TRS(Mpa)	Recommended Application
KY38	10	14.50	88.5	3100	<ol style="list-style-type: none"> 1. Low drilling pressure bits; Insert profile: short crown height and simple crown shape; 2. Suitable for hard rock formation or nonferrous metals mine; 3. Wear resistance is better than YK38.
KY40	11	14.40	87.5	2900	<ol style="list-style-type: none"> 1. Medium drilling pressure bits; Insert profile: medium crown height; 2. Suitable for medium hard or hard rock formation.
KY45	13	14.25	87.5	3100	<ol style="list-style-type: none"> 1. Medium drilling pressure bits; Insert profile: medium crown height; 2. Suitable for medium hard or hard rock formation; 3. Wear resistance is higher than KK45.
KY60	16	13.95	86.5	3100	<ol style="list-style-type: none"> 1. Insert profile: high crown height and complex crown shape; 2. High drilling pressure bits; 3. Suitable for extra hard or complex formation.
KK38	10	14.50	87.5	2900	<ol style="list-style-type: none"> 1. Low drilling pressure bits; Insert profile: short crown height and simple crown shape; 2. Suitable for hard formation or nonferrous metals mine.
KK40	11	14.40	87.0	2900	<ol style="list-style-type: none"> 1. Insert profile: short crown height and simple crown shape; 2. Suitable for medium soft or hard formation.
KK50	15	14.00	85.5	2900	<ol style="list-style-type: none"> 1. Insert profile: medium crown height and complex crown shape; 2. High drilling pressure bits; 3. Suitable for medium hard or hard formation.
KK06	6	14.95	90.0	2600	Suitable for heel, shirttail and serrated insert.
KK30	8	14.75	88.5	2800	Suitable for heel, shirttail and serrated insert.

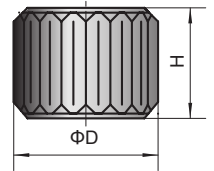
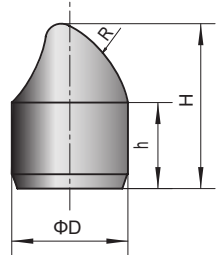
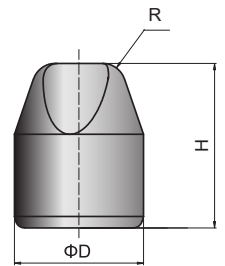
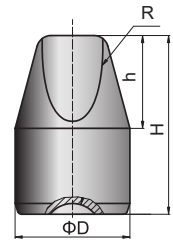

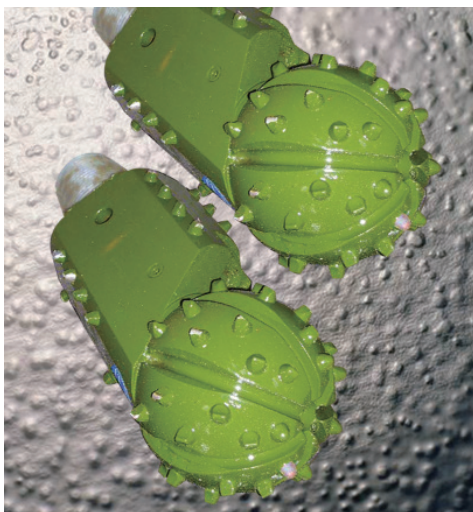
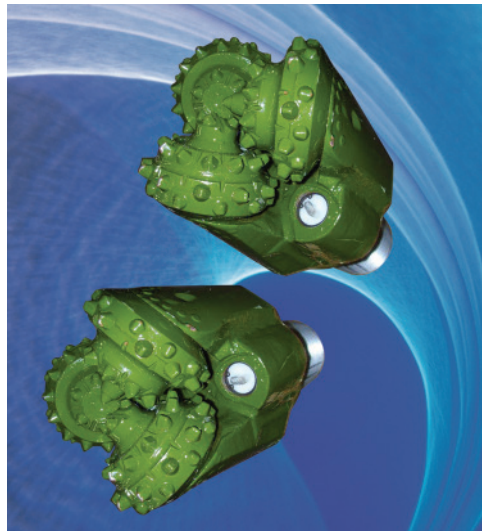

E

Insert for Oil & Gas Tricone Bit

Suitable for oil & gas tricone bits, products quality is in the leading position in the industry. Products can be customized according to clients' request.



JIANGXI YATECH MATERIALS CO., LTD.

**Address: Room 7h, 7th Floor, Building 1, Yida Blue
Bay Business Center, Jiujiang City, Jiangxi
Province, China**

E-mail: yatech@yatechmaterials.com